

LEGEND

	ELEC	ELECTRICAL
	W	WATER LINE
		BEAM
		WALL APPROX LOCATION
		CONDUITS
		HIGH PROBABILITY OF VOIDS
		LOW PROBABILITY OF VOIDS
		SATURATED SOIL
		DOUBLE S.O.G
		UNKNOWN
	○	COLUMN
	□	COLUMN
	○	COLUMN
	◦	ELECTRICAL BOX
		UTILITY LINE CONTINUES BEYOND SITE BOUNDARY

GENERAL NOTES

1. SURVEY OF SUBSURFACE VOIDS WAS COMPLETED BY GEOSCAN SUBSURFACE SURVEYS IN OCTOBER 2016. CHANGES TO THE SITE THAT OCCURRED FOLLOWING OUR INVESTIGATION WILL NOT BE SHOWN.
2. THE GEOPHYSICAL SURVEY WAS PERFORMED USING MULTI-FREQUENCY GROUND PENETRATING RADAR (GPR) EQUIPMENT.
3. DEPTH PENETRATION OF THE GPR SIGNAL VARIES DUE TO SITE CONDITIONS, AND IS DEPENDENT ON VARIOUS FACTORS, SUCH AS CONCRETE SLAB TYPE, REINFORCING SPACING AND GROUND MATERIAL.
4. DEPTH MEASUREMENTS ARE APPROXIMATE AND DEPEND ON THE DEPTH AND SIZE OF THE SUBSURFACE FEATURE.
5. LIMIT OF INVESTIGATION: PENETRATION DEPTH OF GPR APPROXIMATELY 5 FEET IN GRID 1, 1.25 FEET IN GRIDS 2 & 3.
6. UTILITIES BELOW THE CONCRETE SLAB WITHIN THE INVESTIGATED AREA IS NOT SHOWN ON THE DRAWING.
7. GEOSCAN USED AVAILABLE MEANS IN AN ATTEMPT TO DETERMINE THE LOCATION OF SUBSURFACE VOIDS, HOWEVER, CANNOT BE RESPONSIBLE FOR FINDING ALL SUBSURFACE VOIDS.

DISCLAIMER
 GEOSCAN SUBSURFACE SURVEYS INC. IS NOT RESPONSIBLE FOR ANY LOSS OR DAMAGE ARISING OUT OF THE USE OF, OR RELIANCE ON, THE SUBSURFACE DATA COLLECTED OR THE REPORT PRESENTED. THIS DRAWING HAS BEEN PREPARED FOR THE USE OF GEOSCAN SUBSURFACE SURVEYS' CLIENT, AND MAY NOT BE USED, REPRODUCED, OR RELIED UPON BY THIRD PARTIES.



CLIENT

REV	DATE	DESCRIPTION	SURVEYED	DRAWN
1	16.10.05	VOIDS INVESTIGATION	WM	AC

PROJECT

SCALE 1-1/2":1'-0"	SUBSURFACE VOIDS INVESTIGATION
PROJECT NUMBER: J160728-06	
DRAWING NUMBER: J160728-06	TITLE OVERVIEW OF SURVEY AREA
	SHEET NUMBER 1 OF 3

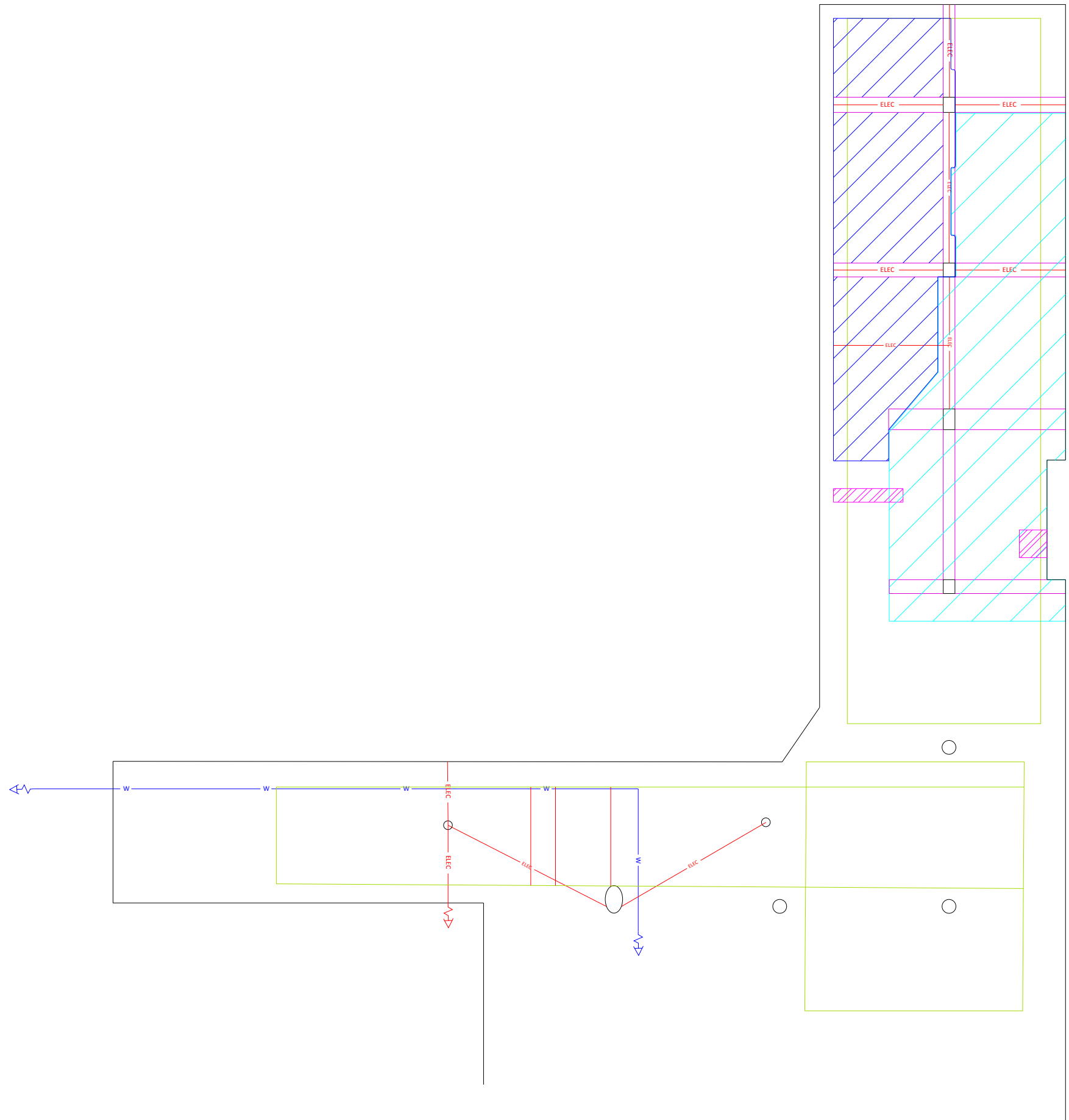

LEGEND

	ELECTRICAL
	WATER LINE
	BEAM
	WALL APPROX LOCATION
	CONDUITS
	HIGH PROBABILITY OF VOIDS
	LOW PROBABILITY OF VOIDS
	SATURATED SOIL
	DOUBLE S.O.G
	UNKNOWN
	COLUMN
	COLUMN
	COLUMN
	ELECTRICAL BOX
	UTILITY LINE CONTINUES BEYOND SITE BOUNDARY

GENERAL NOTES

1. SURVEY OF SUBSURFACE VOIDS WAS COMPLETED BY GEOSCAN SUBSURFACE SURVEYS IN OCTOBER 2016. CHANGES TO THE SITE THAT OCCURRED FOLLOWING OUR INVESTIGATION WILL NOT BE SHOWN.
2. THE GEOPHYSICAL SURVEY WAS PERFORMED USING MULTI-FREQUENCY GROUND PENETRATING RADAR (GPR) EQUIPMENT.
3. DEPTH PENETRATION OF THE GPR SIGNAL VARIES DUE TO SITE CONDITIONS, AND IS DEPENDENT ON VARIOUS FACTORS, SUCH AS CONCRETE SLAB TYPE, REINFORCING SPACING AND GROUND MATERIAL.
4. DEPTH MEASUREMENTS ARE APPROXIMATE AND DEPEND ON THE DEPTH AND SIZE OF THE SUBSURFACE FEATURE.
5. LIMIT OF INVESTIGATION: PENETRATION DEPTH OF GPR APPROXIMATELY 5 FEET IN GRID 1, 1.25 FEET IN GRIDS 2 & 3.
6. UTILITIES BELOW THE CONCRETE SLAB WITHIN THE INVESTIGATED AREA IS NOT SHOWN ON THE DRAWING.
7. GEOSCAN USED AVAILABLE MEANS IN AN ATTEMPT TO DETERMINE THE LOCATION OF SUBSURFACE VOIDS, HOWEVER, CANNOT BE RESPONSIBLE FOR FINDING ALL SUBSURFACE VOIDS.

DISCLAIMER
 GEOSCAN SUBSURFACE SURVEYS INC. IS NOT RESPONSIBLE FOR ANY LOSS OR DAMAGE ARISING OUT OF THE USE OF, OR RELIANCE ON, THE SUBSURFACE DATA COLLECTED OR THE REPORT PRESENTED. THIS DRAWING HAS BEEN PREPARED FOR THE USE OF GEOSCAN SUBSURFACE SURVEYS' CLIENT, AND MAY NOT BE USED, REPRODUCED, OR RELIED UPON BY THIRD PARTIES.



CLIENT

REV	DATE	DESCRIPTION	SURVEYED	DRAWN
1	16.10.05	VOIDS INVESTIGATION	WM	AC

PROJECT

SCALE 1-1/2":1'-0"	SUBSURFACE VOIDS INVESTIGATION

PROJECT NUMBER: J160728-06
 TITLE: RESULTS - SLAB TYPES & CONDUITS

DRAWING NUMBER: J160728-06
 SHEET NUMBER 2 OF 3

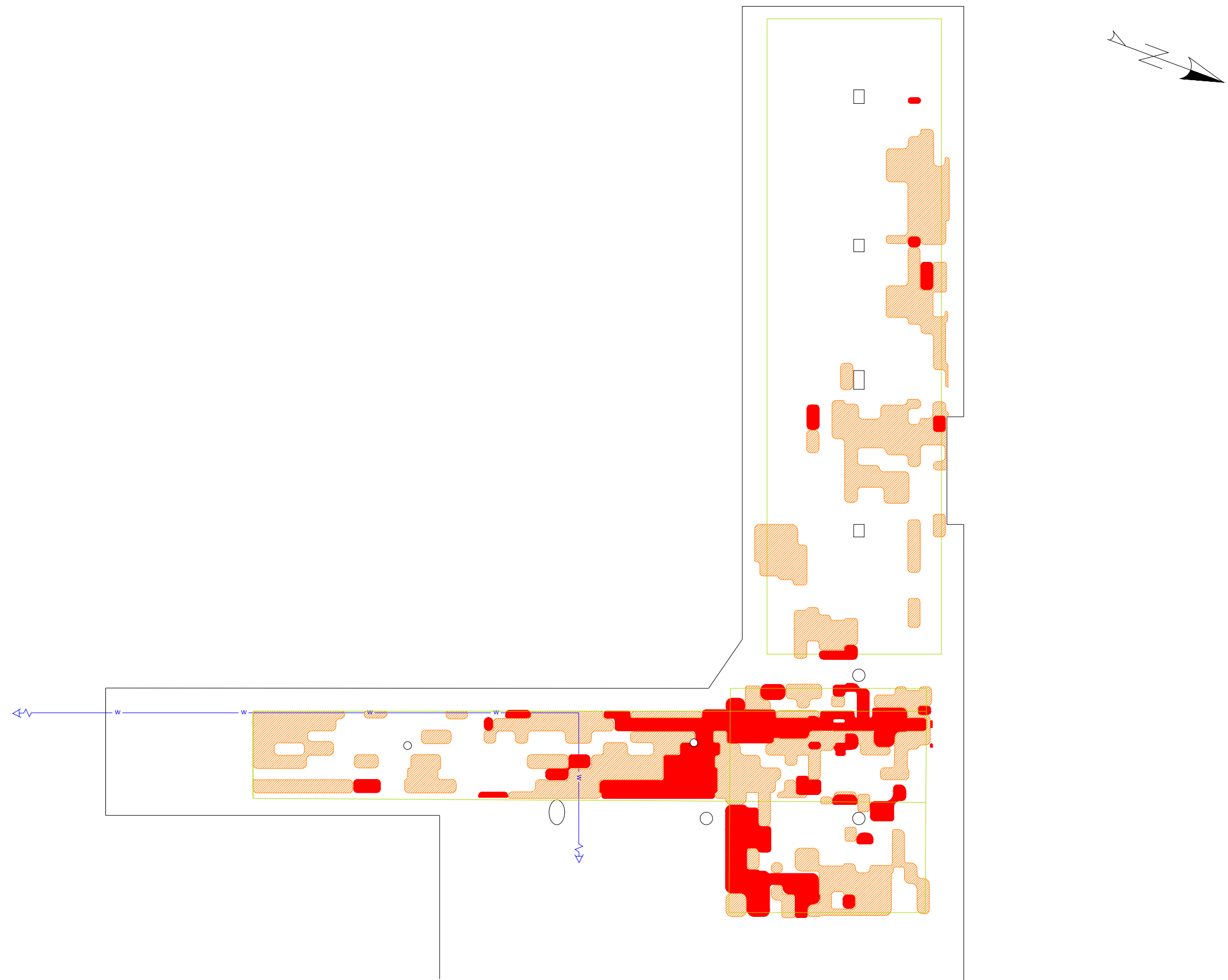

LEGEND

	ELEC	ELECTRICAL
	W	WATER LINE
		BEAM
		WALL APPROX LOCATION
		CONDUITS
		HIGH PROBABILITY OF VOIDS
		LOW PROBABILITY OF VOIDS
		SATURATED SOIL
		DOUBLE S.O.G
		UNKNOWN
	○	COLUMN
	□	COLUMN
	○	COLUMN
	◦	ELECTRICAL BOX
		UTILITY LINE CONTINUES BEYOND SITE BOUNDARY

GENERAL NOTES

1. SURVEY OF SUBSURFACE VOIDS WAS COMPLETED BY GEOSCAN SUBSURFACE SURVEYS IN OCTOBER 2016. CHANGES TO THE SITE THAT OCCURRED FOLLOWING OUR INVESTIGATION WILL NOT BE SHOWN.
2. THE GEOPHYSICAL SURVEY WAS PERFORMED USING MULTI-FREQUENCY GROUND PENETRATING RADAR (GPR) EQUIPMENT.
3. DEPTH PENETRATION OF THE GPR SIGNAL VARIES DUE TO SITE CONDITIONS, AND IS DEPENDENT ON VARIOUS FACTORS, SUCH AS CONCRETE SLAB TYPE, REINFORCING SPACING AND GROUND MATERIAL.
4. DEPTH MEASUREMENTS ARE APPROXIMATE AND DEPEND ON THE DEPTH AND SIZE OF THE SUBSURFACE FEATURE.
5. LIMIT OF INVESTIGATION: PENETRATION DEPTH OF GPR APPROXIMATELY 5 FEET IN GRID 1, 1.25 FEET IN GRIDS 2 & 3.
6. UTILITIES BELOW THE CONCRETE SLAB WITHIN THE INVESTIGATED AREA IS NOT SHOWN ON THE DRAWING.
7. GEOSCAN USED AVAILABLE MEANS IN AN ATTEMPT TO DETERMINE THE LOCATION OF SUBSURFACE VOIDS, HOWEVER, CANNOT BE RESPONSIBLE FOR FINDING ALL SUBSURFACE VOIDS.

DISCLAIMER
 GEOSCAN SUBSURFACE SURVEYS INC. IS NOT RESPONSIBLE FOR ANY LOSS OR DAMAGE ARISING OUT OF THE USE OF, OR RELIANCE ON, THE SUBSURFACE DATA COLLECTED OR THE REPORT PRESENTED. THIS DRAWING HAS BEEN PREPARED FOR THE USE OF GEOSCAN SUBSURFACE SURVEYS' CLIENT, AND MAY NOT BE USED, REPRODUCED, OR RELIED UPON BY THIRD PARTIES.



CLIENT

REV	DATE	DESCRIPTION	SURVEYED	DRAWN
1	16.10.05	VOIDS INVESTIGATION	WM	AC

PROJECT

SCALE 1-1/2":1'-0" 	SUBSURFACE VOIDS INVESTIGATION
PROJECT NUMBER: J160728-06	TITLE RESULTS - SUBSURFACE VOIDS
DRAWING NUMBER: J160728-06	SHEET NUMBER 3 OF 3